

**TMG50N06D**

**N-Channel Enhancement Mosfet**

<p><b>General Description</b></p> <ul style="list-style-type: none"> <li>• Low R<sub>DS(ON)</sub></li> <li>• RoHS and Halogen-Free Compliant</li> </ul> <p><b>Applications</b></p> <ul style="list-style-type: none"> <li>• Load switch</li> <li>• PWM</li> </ul>	<p><b>General Features</b></p> <p>V<sub>DS</sub> = 60V I<sub>D</sub> = 50A R<sub>DS(ON)</sub> = 11 mΩ (typ.) @ V<sub>GS</sub> = 10V</p> <p>100% UIS Tested 100% R<sub>g</sub> Tested</p> 
---	--

D:TO-252-3L

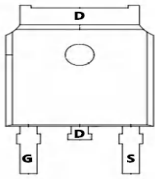

Marking: G50N06

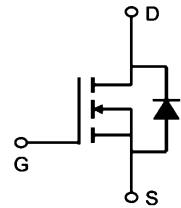
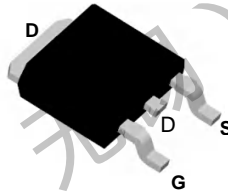

**Absolute Maximum Ratings** (T<sub>C</sub> = 25°C Unless Otherwise Noted)

Symbol	Parameter	Rating	Units
V <sub>DS</sub>	Drain-Source Voltage	60	V
V <sub>GS</sub>	Gate-Source Voltage	±20	V
I <sub>D</sub> @T <sub>C</sub> =25°C	Continuous Drain Current, V <sub>GS</sub> @ 10V <sup>1</sup>	50	A
I <sub>D</sub> @T <sub>C</sub> =100°C	Continuous Drain Current, V <sub>GS</sub> @ 10V <sup>1</sup>	32.5	A
I <sub>DM</sub>	Pulsed Drain Current <sup>2</sup>	185	A
P <sub>D</sub> @T <sub>C</sub> =25°C	Total Power Dissipation <sup>3</sup>	35	W
T <sub>STG</sub>	Storage Temperature Range	-55 to 150	°C
T <sub>J</sub>	Operating Junction Temperature Range	-55 to 150	°C

**Thermal Data**

Symbol	Parameter	Typ.	Max.	Unit
R <sub>θJA</sub>	Thermal Resistance Junction-ambient <sup>1</sup>	---	62	°C/W
R <sub>θJC</sub>	Thermal Resistance Junction-Case <sup>1</sup>	---	6.6	°C/W

**TMG50N06D**

**N-Channel Enhancement Mosfet**

Electrical Characteristics: ( $T_C=25^{\circ}\text{C}$  unless otherwise noted)

Symbol	Parameter	Conditions	Min	Typ	Max	Units
<b>Off Characteristics</b>						
$BV_{DSS}$	Drain-Source Breakdown Voltage	$V_{GS}=0V, I_D=250 \mu A$	60	---	---	V
$I_{DSS}$	Zero Gate Voltage Drain Current	$V_{GS}=0V, V_{DS}=48V$	---	---	1	$\mu A$
$I_{GSS}$	Gate-Source Leakage Current	$V_{GS}=\pm 20V, V_{DS}=0A$	---	---	$\pm 100$	nA
<b>On Characteristics</b>						
$V_{GS(th)}$	GATE-Source Threshold Voltage	$V_{GS}=V_{DS}, I_D=250 \mu A$	1.0	2.0	3.0	V
$R_{DS(on)}^a$	Drain-Source On Resistance	$V_{GS}=10V, I_D=12A$	---	11	16	m $\Omega$
		$V_{GS}=4.5V, I_D=8A$	---	16	25	
<b>Dynamic Characteristics</b>						
$C_{iss}$	Input Capacitance	$V_{DS}=30V, V_{GS}=0V, f=1MHz$	---	438	---	pF
$C_{oss}$	Output Capacitance		---	225	---	
$C_{rss}$	Reverse Transfer Capacitance		---	28	---	
<b>Switching Characteristics</b>						
$t_{d(on)}$	Turn-On Delay Time	$V_{DD}=30V, I_D=12A,$ $V_{GS}=10V, R_{GEN}=4.5\Omega$ $R_L=2.5\Omega$	---	6.2	---	ns
$t_r$	Rise Time		---	23	---	ns
$t_{d(off)}$	Turn-Off Delay Time		---	13	---	ns
$t_f$	Fall Time		---	17	---	ns
$Q_g$	Total Gate Charge	$V_{GS}=10V, V_{DS}=30V,$ $I_D=12A$	---	15	---	nC
$Q_{gs}$	Gate-Source Charge		---	3.6	---	nC
$Q_{gd}$	Gate-Drain "Miller" Charge		---	3.6	---	nC
<b>Drain-Source Diode Characteristics</b>						
$V_{SD}^a$	Source-Drain Diode Forward Voltage	$V_{GS}=0V, I_S=12A$	---	---	1.3	V
$trr$	Reverse Recovery Time	$I_{DS} = 12 A, V_{GS} = 0 V$	---	31	---	Ns
$qrr$	Reverse Recovery Charge	$di_{SD}/dt = 100 A/\mu s$	---	11	---	nc

**Notes:**

\* Pulse width  $\leq 300 \mu s$ , duty cycle  $\leq 2 \%$

\*\* Mounted on Large Heat Sink

\*\*\* limited by bonding wire

a : Pulse test ; pulse width  $\leq 300 \mu s$ , duty cycle  $\leq 2\%$

b : Guaranteed by design, not subject to production testing

TMG50N06D

N-Channel Enhancement Mosfet

Typical Characteristics

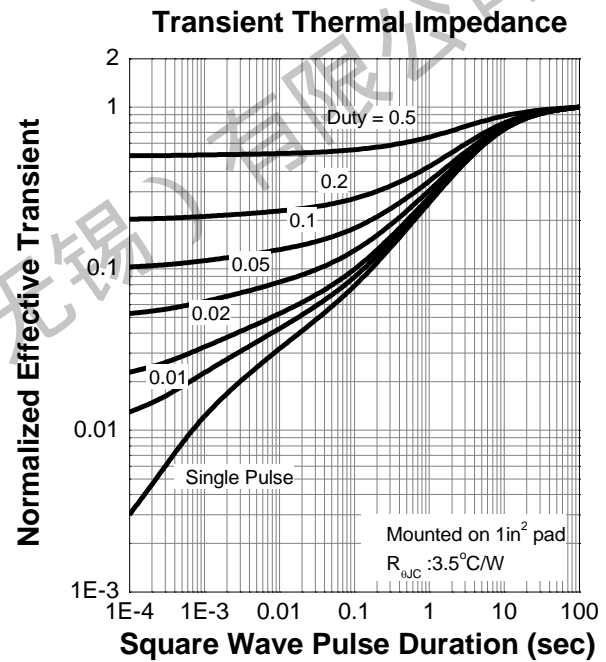
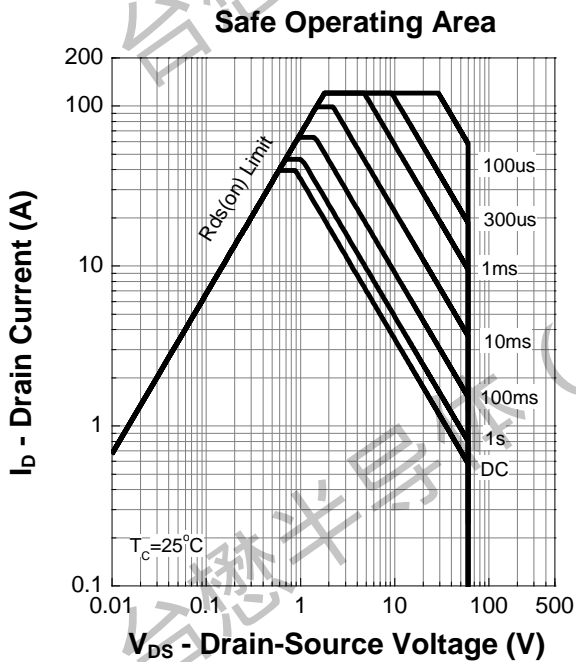
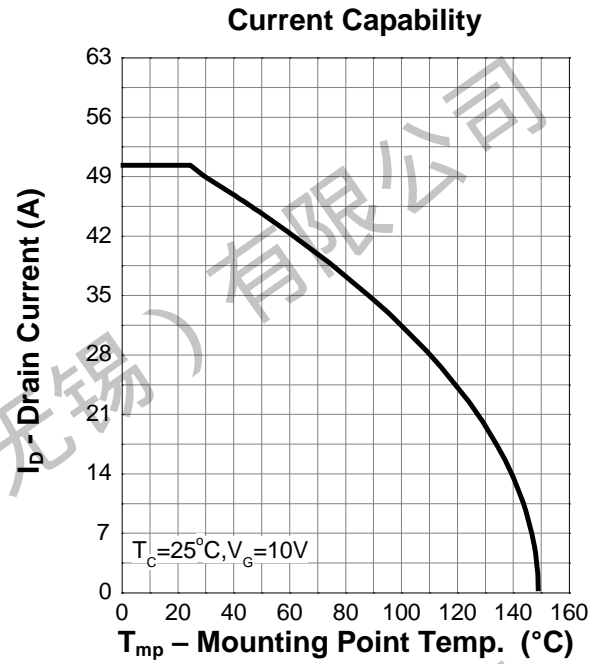
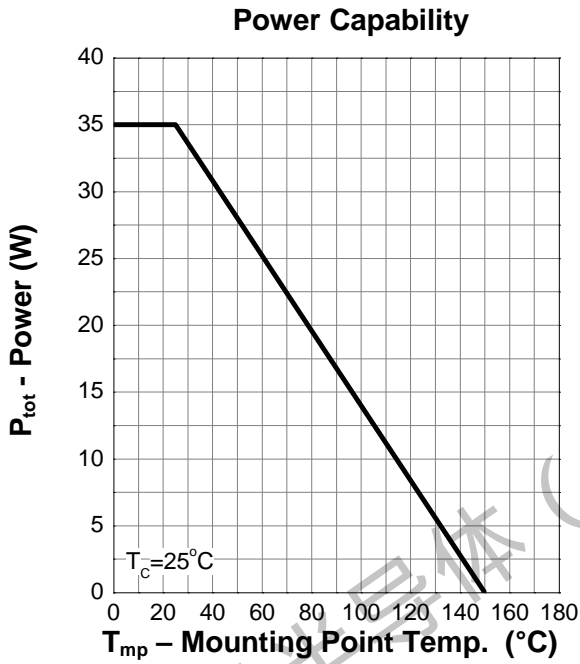

TMG50N06D

N-Channel Enhancement Mosfet

Output Characteristics

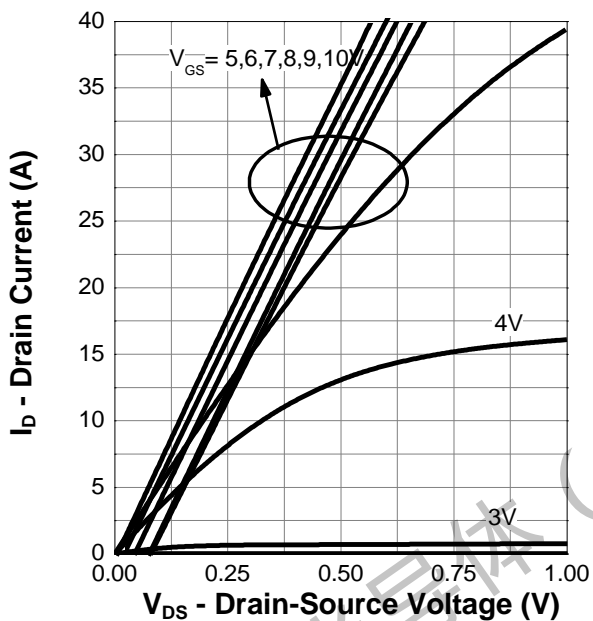

On Resistance

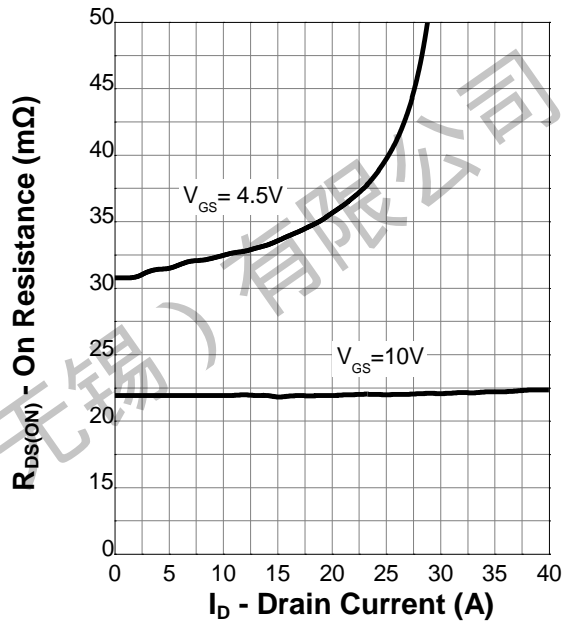

Transfer Characteristics

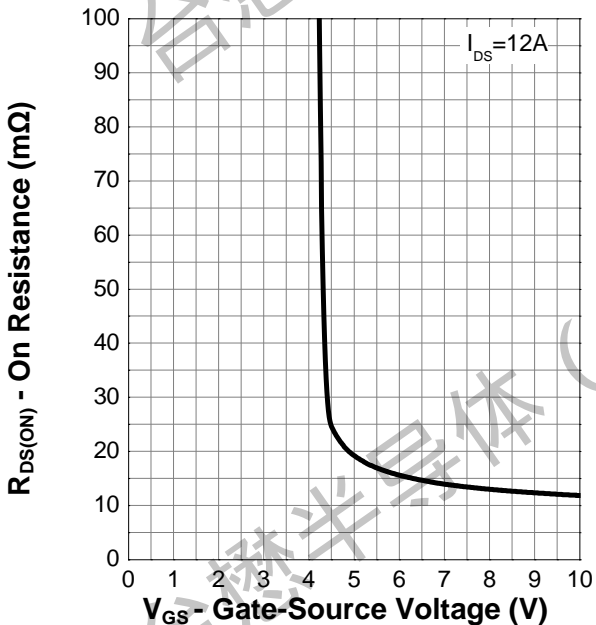

Normalized Threshold Voltage

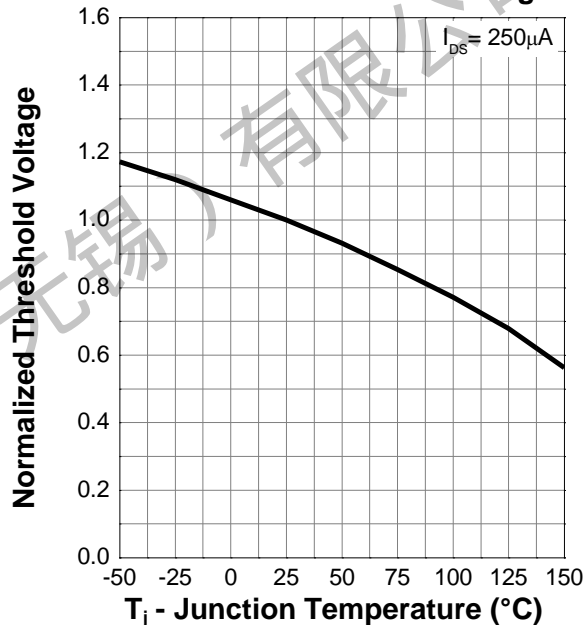



TMG50N06D

N-Channel Enhancement Mosfet

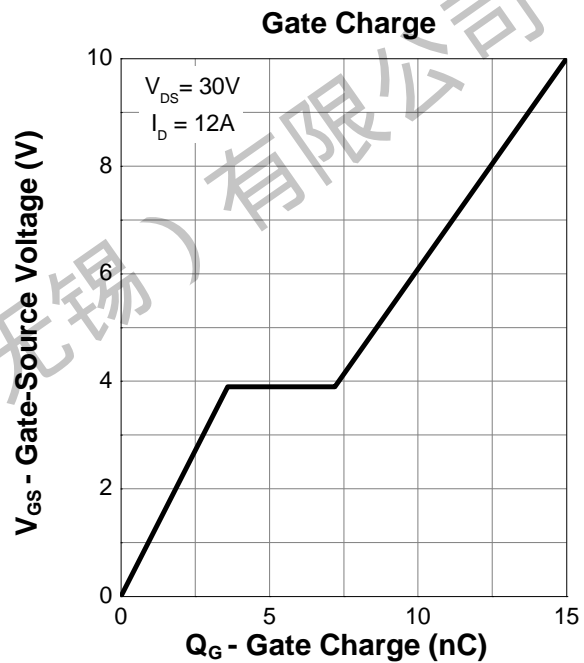
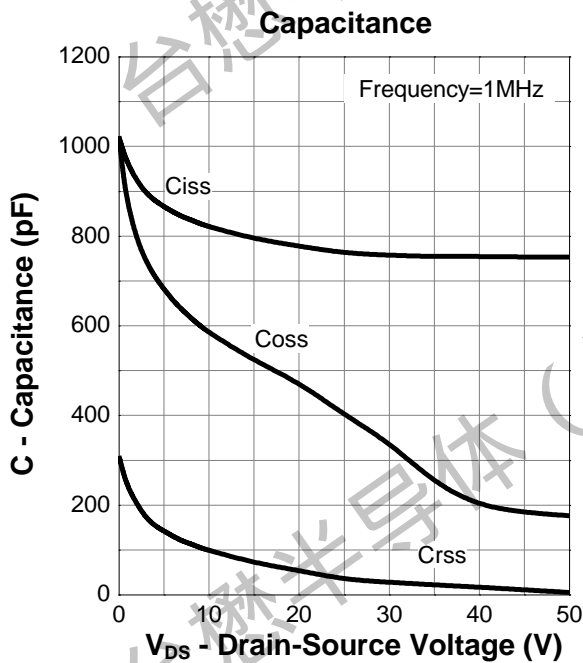
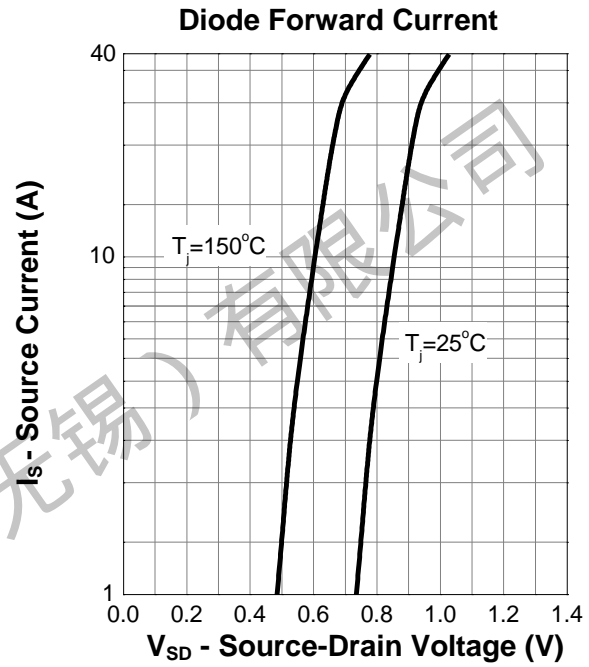
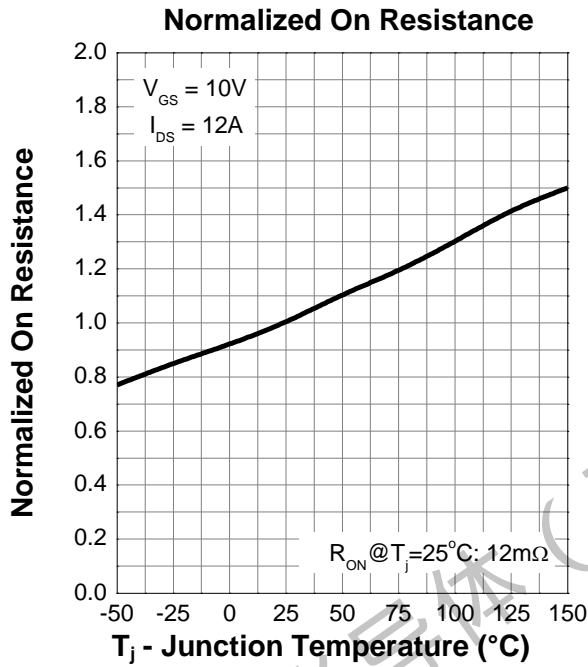

TMG50N06D

N-Channel Enhancement Mosfet

Package Mechanical Data: TO-252-3L

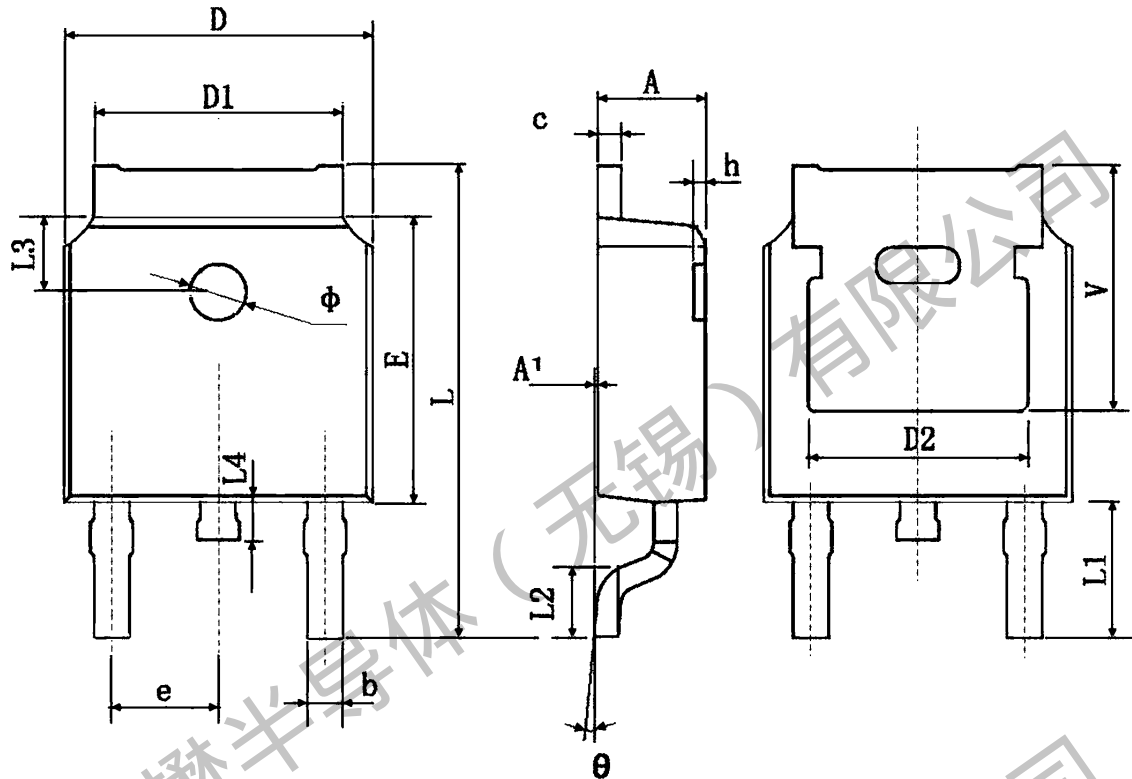

Symbol	Dimensions In Millimeters		Dimensions In Inches	
	Min.	Max.	Min.	Max.
A	2.200	2.400	0.087	0.094
A1	0.000	0.127	0.000	0.005
b	0.660	0.860	0.026	0.034
c	0.460	0.580	0.018	0.023
D	6.500	6.700	0.256	0.264
D1	5.100	5.460	0.201	0.215
D2	4.830 TYP.		0.190 TYP.	
E	6.000	6.200	0.236	0.244
e	2.186	2.386	0.086	0.094
L	9.800	10.400	0.386	0.409
L1	2.900 TYP.		0.114 TYP.	
L2	1.400	1.700	0.055	0.067
L3	1.600 TYP.		0.063 TYP.	
L4	0.600	1.000	0.024	0.039
φ	1.100	1.300	0.043	0.051
θ	0°	8°	0°	8°
h	0.000	0.300	0.000	0.012
V	5.350 TYP.		0.211 TYP.	

**TMG50N06D**

**N-Channel Enhancement Mosfet**

TO-252-3L Embossed Carrier Tape

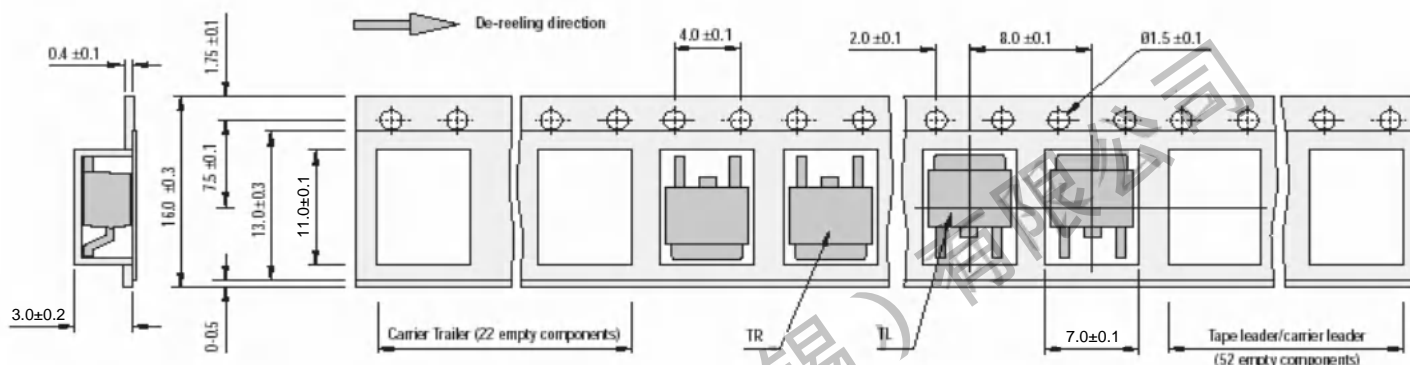

TO-252-3L Reel

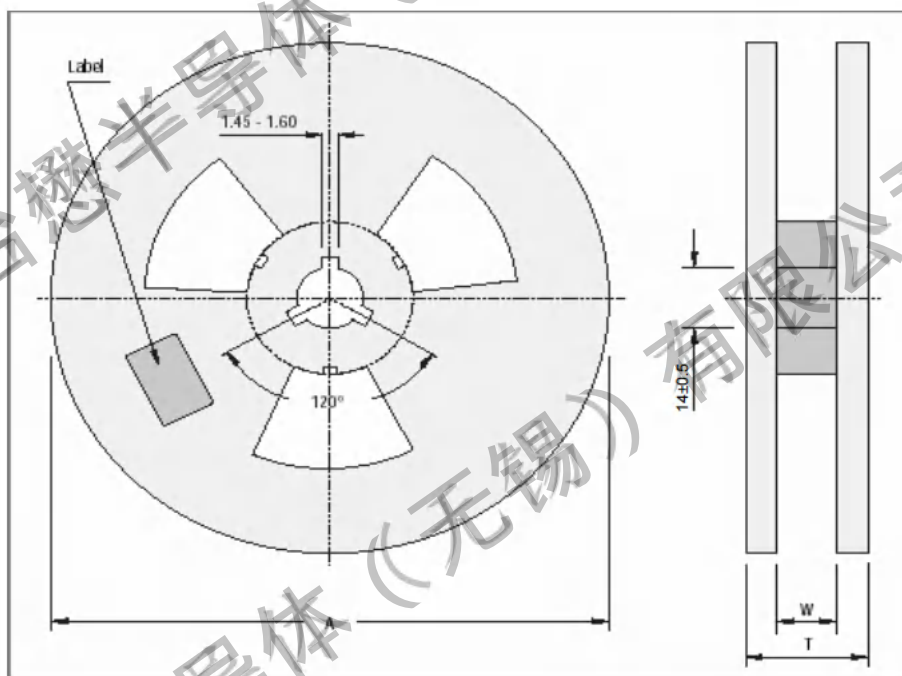

All Dimensions are in mm.

Reel Specifications				
Package	Tape Width	Reel Dia. A - Max	Inside Thickness W	Reel Thickness T - max
TO-252-3L	16	330	18.0 ±1.5	20

**Packaging Information**

REEL	Reel Size	Box	Box Size(mm)	Carton	Carton Size(mm)	G.W.(kg)
2,500 pcs	13 inch	5,000 pcs	355×370×50	25,000 pcs	380×275×380	

### Important Notices and Disclaimers

- Tritech-MOS Technology Corp. reserves the right to change this document, its products, and specifications at any time without prior notice.
- Before final design, purchase, or use, customers should obtain and confirm the latest product information and specifications.
- Tritech-MOS Technology Corp. makes no warranties, representations or warranties regarding the suitability of its products for any specific purpose, and Tritech-MOS Technology Corp. does not assume any responsibility for application assistance or customer product design.
- Tritech-MOS Technology Corp. does not guarantee or assume any responsibility for the purchase or use of any unexpected or unauthorized products.
- Any intellectual property rights of Tritech-MOS Technology Corp. are not licensed through implicate or other means.
- Products of Tritech-MOS Technology Corp. are not included as critical components in life support equipment or systems without explicit written approval from Tritech-MOS Technology Corp.

Revision history:

Date	Rev	Description	Page
2023.05.09	23.05	Original	